

# A2 Sydenham Bypass Improvement Scheme



## Public Consultation Event

Wednesday 14th and Thursday 15th May 2008

Park Avenue Hotel  
158 Hollywood Road,  
Belfast

### Getting and Staying Involved

All comments received from this public consultation will be considered during the Stage 2 Assessment process and will help inform the decision making process. The stages of the scheme assessment process are detailed below.

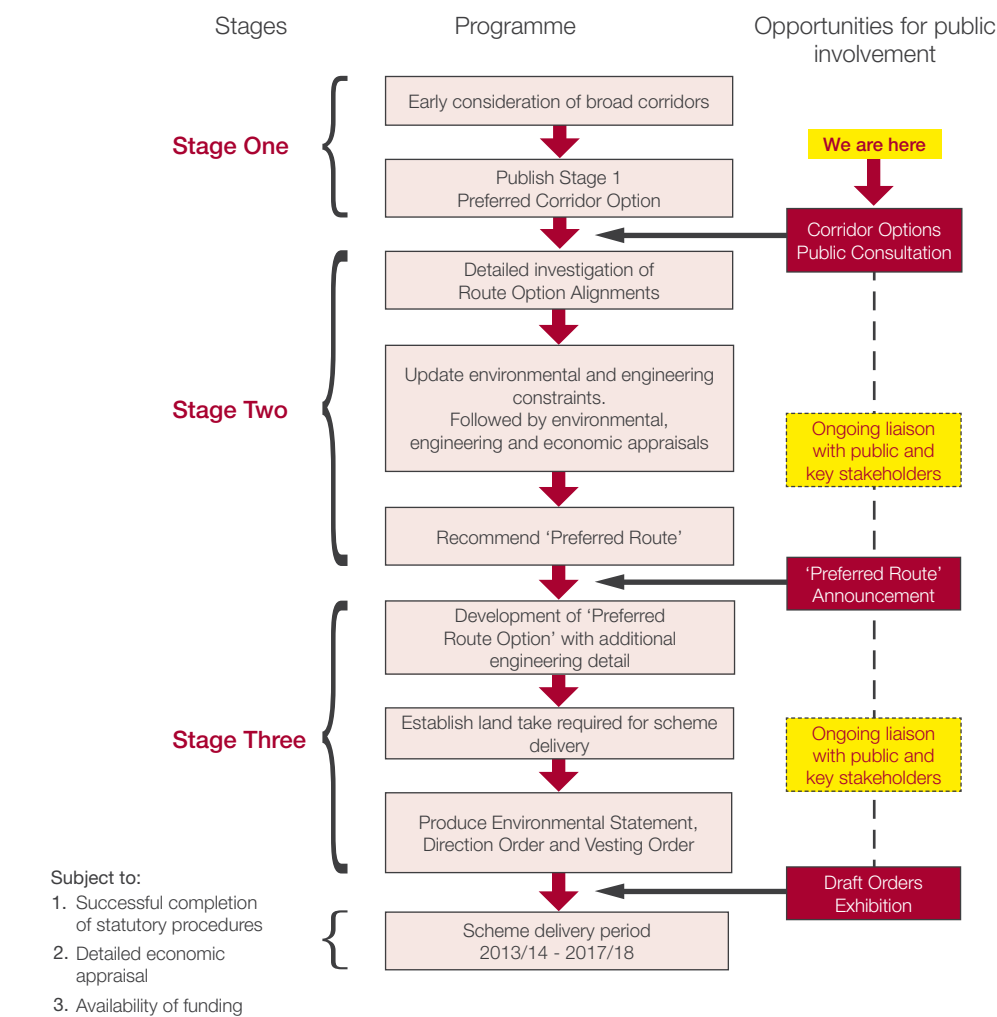

Please use the feedback section of this leaflet to give us your views on the Preferred Route Corridor and Dee Street Bridge options. Please drop the feedback form attached to this leaflet in the box provided on your exit or post to Roads Service at the address below. All comments should be received by the 20th of June 2008.

**Divisional Roads Manager**  
Roads Service  
Eastern Division  
Hydebank  
4 Hospital Road  
Belfast  
BT8 8JL  
Tel: 028 90253276  
Email: roads.sriteastern@drdni.gov.uk

Copies of the Stage 1 Assessment Report maybe purchased on request from the above address from June 2008. Paper copies of the report will be charged at £150, including postage and electronic copies on CD will be charged at £5. Alternatively the report can be downloaded from the website at:

[http://roadimprovements.roadsni.gov.uk/index/futureschemes/sydenham\\_bypass.htm](http://roadimprovements.roadsni.gov.uk/index/futureschemes/sydenham_bypass.htm)

Should you require further information or a copy of this leaflet in an accessible format eg Braille, audio-cassette, minority ethnic language etc, please contact the Roads Service, Eastern Division at the address above.

## A2 Sydenham Bypass Improvement Scheme Public Consultation

Roads Service are currently assessing the A2 Sydenham Bypass, with the aim of increasing the capacity of the road. The scheme involves improving a 2.5km stretch of the existing A2 dual carriageway from the M3 Lagan Bridge to the Tillysburn Junction.

Public Consultation is an important part of the scheme assessment process and your views are important to us. Your comments on the proposed scheme will help inform the decision making process.

### Why is the Scheme needed?

The A2 Sydenham Bypass Improvement is one of a number of schemes identified within Roads Service's 10 year Regional Transport Strategy for Northern Ireland. This section of the A2 is one of the most heavily used carriageways in the Belfast Metropolitan Area. The A2 Sydenham Bypass forms a vital section of the strategic highway network, linking Bangor and Belfast. The road also provides access to the key gateways of George Best Belfast City Airport, Belfast Port and to several large residential areas. Currently this section of the road is a dual carriageway and carries over 50,000 vehicles per day and suffers from congestion during peak traffic periods.



### The Scheme Assessment Process

The scheme is being developed using a three stage assessment process that is based on the Governments overarching objectives for Transport which are: Environment, Safety, Economy, Accessibility and Integration.

Stage 1: Early consideration of broad corridors for the route

Stage 2: Assessments of routes within preferred corridors leading to a preferred route

Stage 3: Completion of Statutory procedures including Direction Order, Environmental Statement and Vesting Order.

### What has happened so far?

The Stage 1 Scheme Assessment for the route has recently been completed. Stage 1 focused on the assessment of the environmental and engineering constraints within the study area. The constraints identified include; Dee Street Bridge, existing electricity pylons, Connswater Community Greenway Project, Belfast Lough Area of Special Scientific Interest (ASSI), Victoria Park, the Yacht Club, the Belfast to Bangor Railway Line and George Best Belfast City Airport.

In light of these constraints three potential route corridors were identified. The three corridors were then assessed against the Governments five overarching objectives for transport, detailed above. This has led to the identification of the Preferred Route Corridor which is detailed in this leaflet and which we are seeking your comments on.

## The Preferred Route Corridor

The map to the right shows various features of the Preferred Route Corridor. For clarity the issues have been colour coded in the following way:

- Blue:** Pedestrian and cyclist access
- Green:** Environmental
- Orange:** Significant junction alterations
- Purple:** Other road schemes in the area

### Dee Street Bridge Options

In widening the A2 Sydenham Bypass from a dual 2-lane carriageway to a dual 3-lane carriageway, Dee Street bridge will be required to be demolished and replaced to accommodate the widened carriageway.

In order to minimise disruption to traffic, Roads Service plan to keep the existing bridge open to traffic during construction of the new bridge. Once the new bridge is complete, the existing structure will be demolished.

Two options have been considered for the replacement bridge; one on either side of the existing structure. Both options are illustrated below. We seek your views as to which option is preferred.

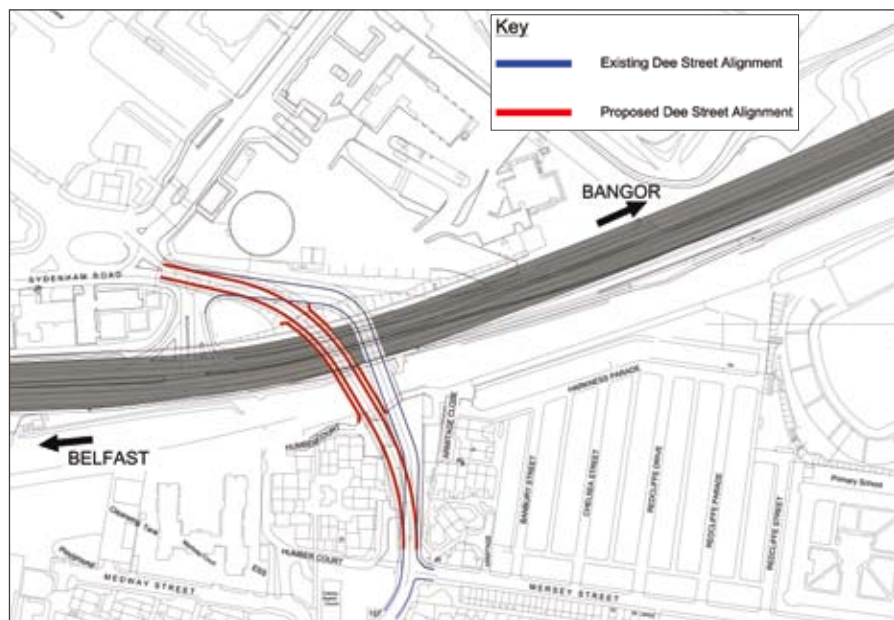

Option 1 - Western Bridge

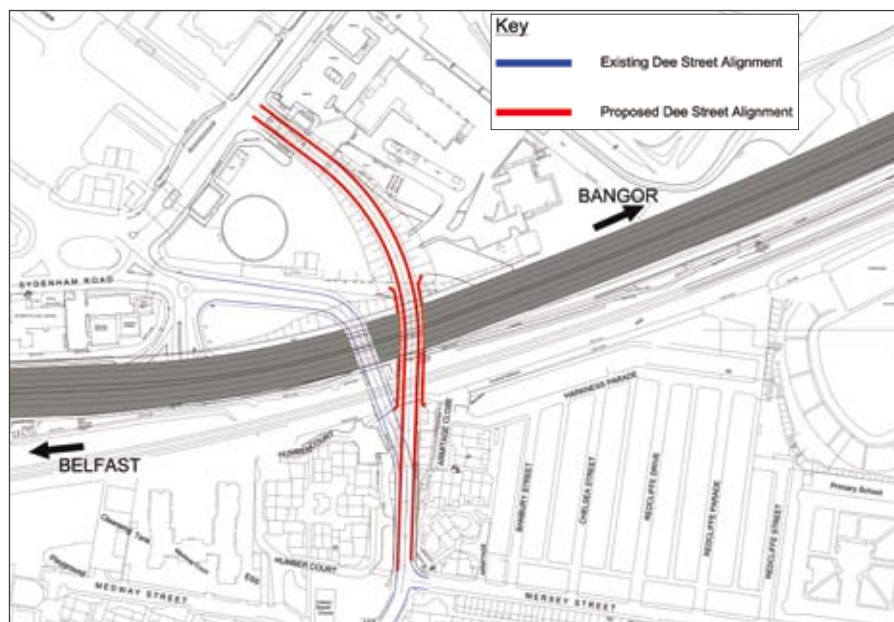

Option 2 - Eastern Bridge

## The Preferred Route Corridor

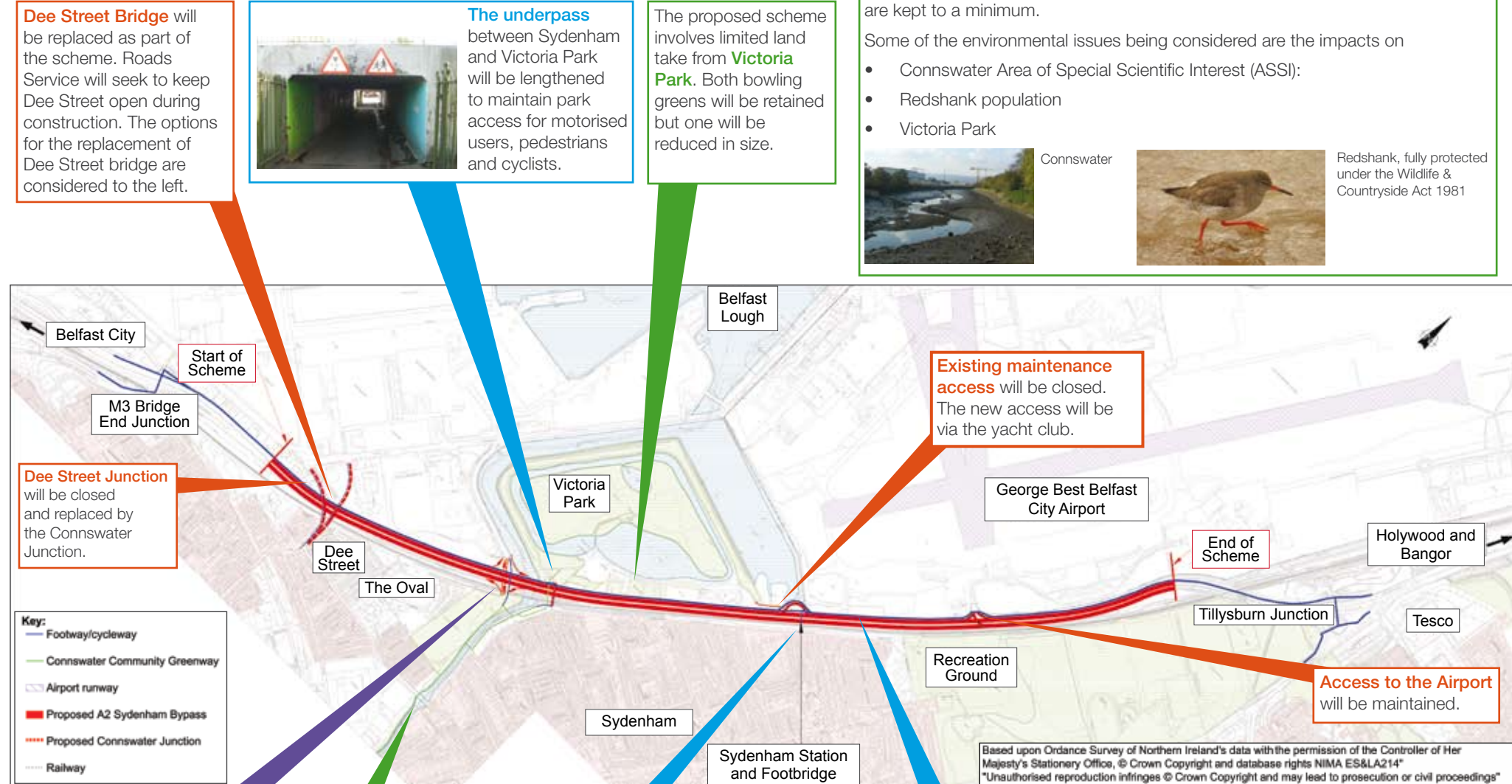

**Connswater Junction**  
As part of Roads Service's A2 Sydenham Bypass Improvement Scheme the Dee Street junction will be removed and access to the A2 will be via the new Connswater junction. The proposals for this junction will be progressed separately via the planning process. We are not carrying out consultation on this junction today. This junction is illustrated merely to show how the two schemes will work in conjunction.

**Connswater Community Greenway Project**  
The pedestrian and cycle access for the proposed A2 Sydenham Improvement Scheme will link up with the Connswater Community Greenway Project proposals, which is for a high quality alternative footbridge.

**The Sydenham footbridge**  
The Sydenham Railway Station and provides access across the existing carriageway. The footbridge will be replaced and upgraded as part of the scheme. Roads Service are working with Translink on this aspect of the scheme.

**Pedestrian and cycle access** will be provided through a high quality shared-use facility on one side of the A2 Sydenham bypass as part of the proposed scheme. The following diagram illustrates the differences between the existing and the proposed pedestrian and cycleway facilities.

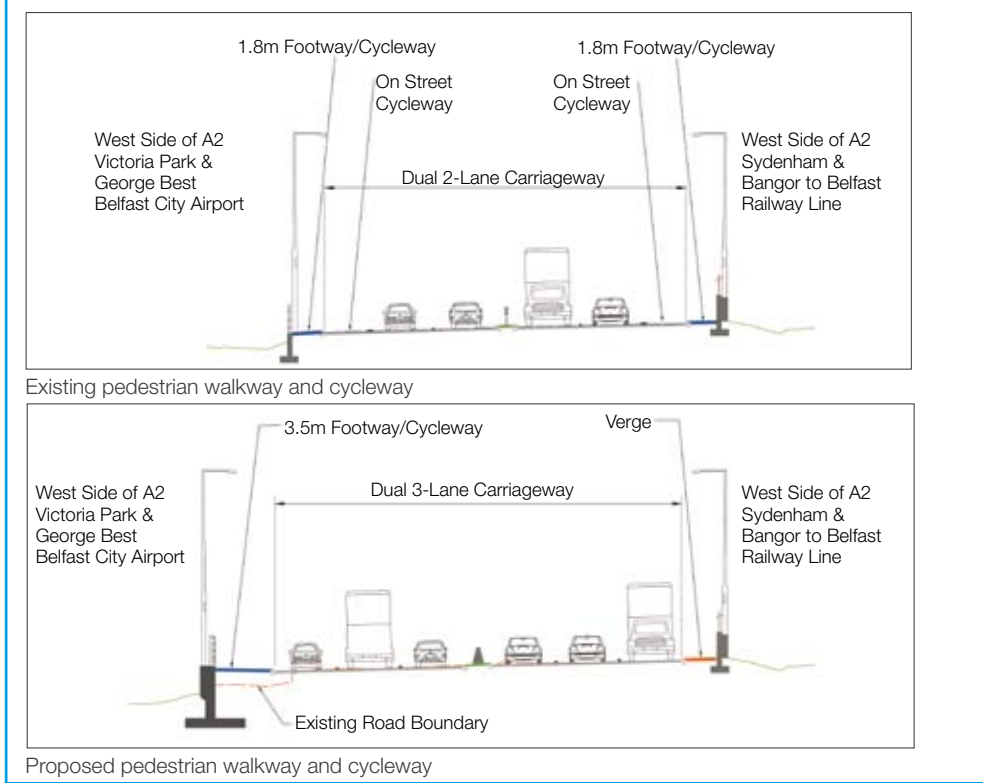

We would seek your views on all aspects of the Preferred Route Corridor shown above and the two options for the realignment of Dee Street Bridge shown on the left.

**The environment** is a key consideration at all stages of the Scheme Assessment process. Roads Service are committed to ensuring impacts on the environment are kept to a minimum.

Some of the environmental issues being considered are the impacts on

- Connswater Area of Special Scientific Interest (ASSI):
- Redshank population
- Victoria Park

Connswater Redshank, fully protected under the Wildlife & Countryside Act 1981

## Feedback

Your views on the Preferred Route Corridor and Dee Street Bridge alignment options presented in this leaflet are important to us. Please write your comments in the space below and either place your completed questionnaire in the box provided at the exhibition or post to the address on the back of this leaflet. Alternatively you can email your comments to [roads.sriteastern@drdni.gov.uk](mailto:roads.sriteastern@drdni.gov.uk)

Please return your comments and feedback by the 20th June 2008.

Please write your name and address below

Name: .....

Address: .....

Post Code: .....

1. Do you support the principle of improving the A2 Sydenham Bypass between the M3 Lagan Bridge Junction to the Tillyburn Junction?

Please tick as appropriate

Yes  No

If No please give reasons

2. Which option for the realignment of Dee Street do you prefer?

Please tick as appropriate

Option 1 Western Bridge  Option 2 Eastern Bridge

3. Please provide any comments on the Preferred Route Corridor and Dee Street realignment presented in this leaflet (additional space for comments is provided on the reverse on this sheet)